

Honda Genuine Accessories

Applicable model
NC700X/XA/XD/D/S/SA/SD

REAR CARRIER INSTALLATION INSTRUCTIONS

Publications No.

Issue Date
July 2012

Honda Dealer:

Please give a copy of these instructions to your customer.

PARTS LIST

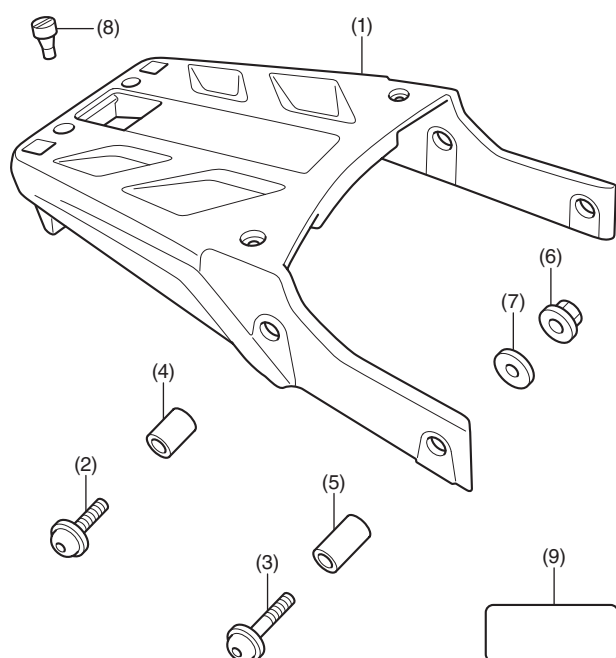

No.	Description	Qty
(1)	Rear carrier	1
(2)	8 mm socket bolt (short)	2
(3)	8 mm socket bolt (long)	2
(4)	Collar (short)	2
(5)	Collar (long)	2
(6)	8 mm flange nut	4
(7)	Washer	4
(8)	Rubber	4
(9)	Caution label	1

PANNIER STAY
Sold separately

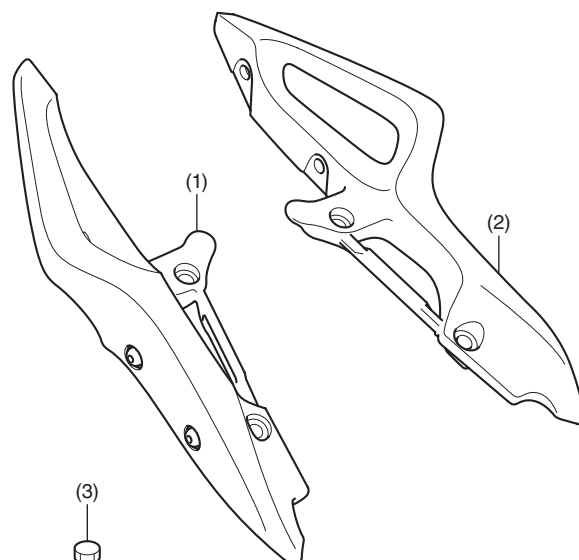

No.	Description	Qty
(1)	Right panner stay	1
(2)	Left panner stay	1
(3)	Plug	4

TOOLS AND SUPPLY REQUIRED

Box-end wrench (12 mm) Hex wrench (5 mm)
File Fretsaw
Scissors Scale
Marker Tape
Isopropyl alcohol Shop towel
Torque wrench

TORQUE CHART

Tighten all screws, bolts, and nuts to their specified torque values. Refer to the Service Manual for the torque values of the removed parts.

Item	N·m	kgf·m	lbf·ft
8 mm flange nut	27	2.8	20
Motorcycle's 8 mm socket bolt	30	3.1	22

USE AND CARE INFORMATION

- The weight of the cargo must not exceed the following maximum weight capacity:

Maximum Weight Capacity	
Rear carrier	10 kg (22 lb)

- Check the accessory mounts frequently and retighten if necessary.
- Added accessories can affect a motorcycle's stability, performance and safe riding speed.

INSTALLATION INFORMATION

NOTE:

- The Pannier stay which is sold separately is required to install this accessory.

- The Pannier stay is not required for the motorcycle equipped with the Pannier stay.
- Heat the bonding surfaces with a hair dryer if the ambient air temperature is below 70°F (21°C).
- The adhesive reaches full strength in 72 hours. Wait at least 24 hours before riding your motorcycle.
- Take care not to damage the painted surfaces of the motorcycle.
- When the motorcycle is already equipped with the Pannier stay, loosen all mounting bolts before installing this accessory.

CONTENTS

Refer to the following page according to each model.

INSTALLATION <NC700X/XA/XD/S/SA/SD> P.2

INSTALLATION <NC700D> P.6

INSTALLATION <NC700X/XA/XD/S/SA/SD>

- Illustration shows NC700XA type, other types are similar.

1. Refer to the Service Manual for the motorcycle, remove the motorcycle parts.

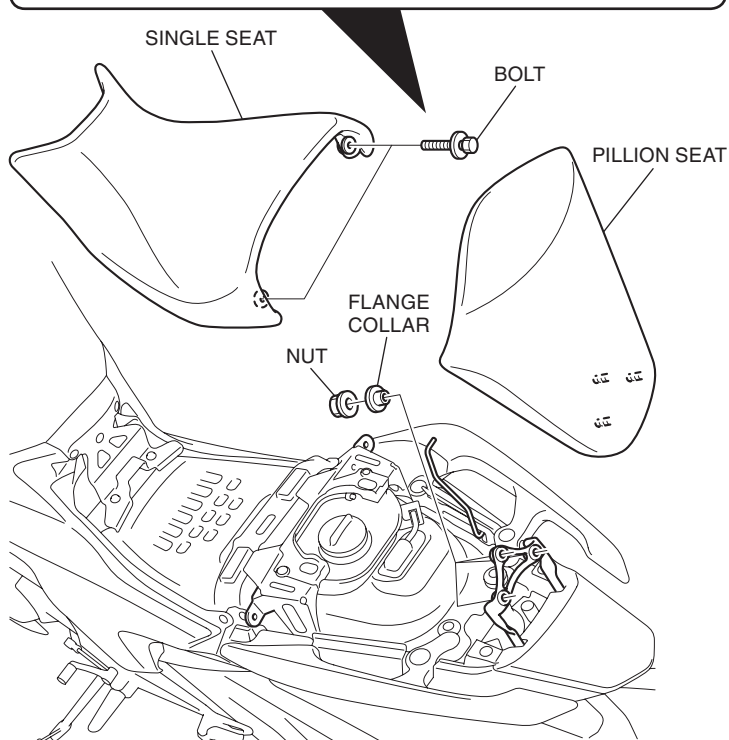
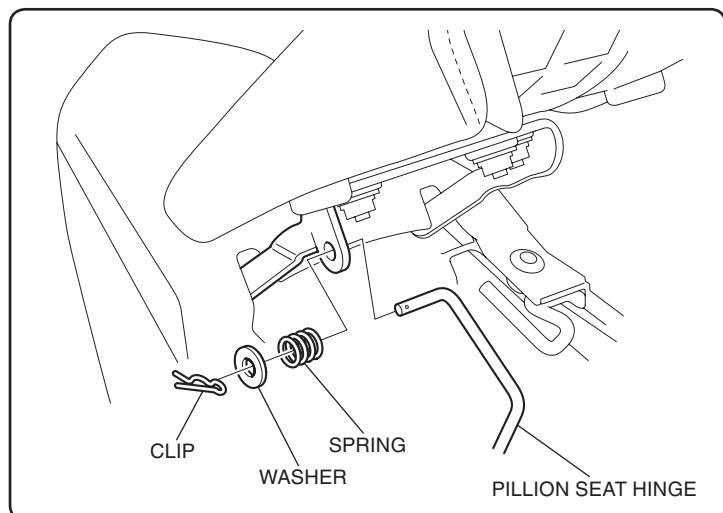

2. Refer to the Service Manual for the motorcycle, remove the motorcycle parts.

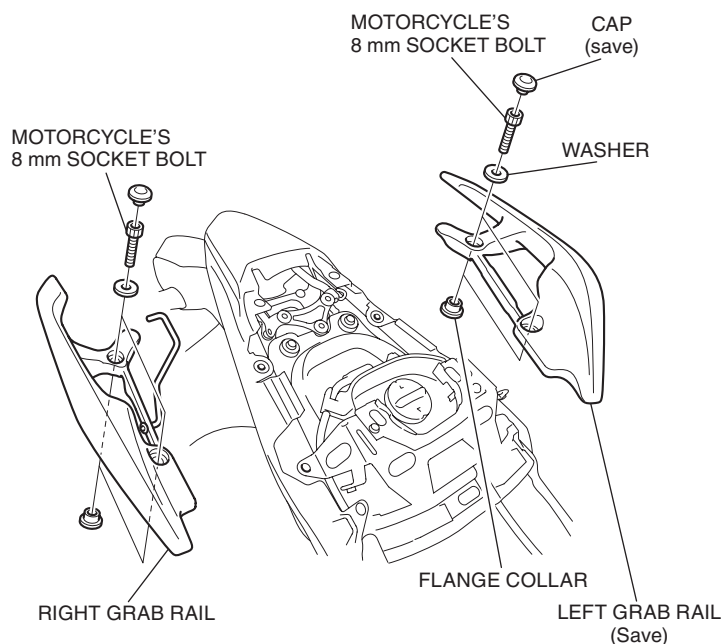

3. Remove the pillion seat hinge as shown.

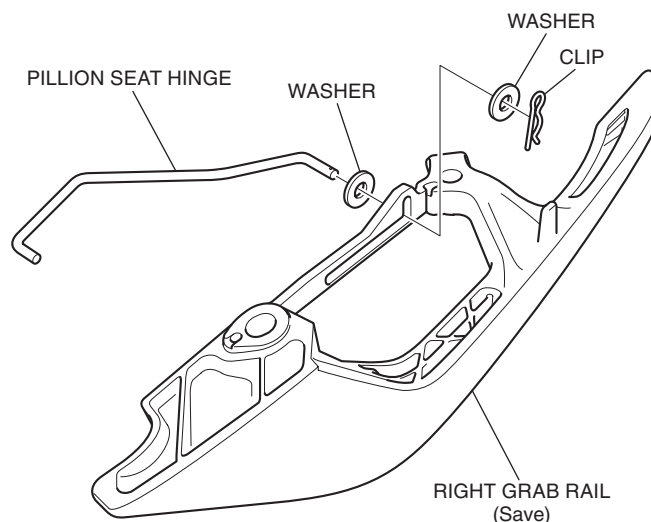

4. Refer to the Service Manual for the motorcycle, remove the motorcycle parts.

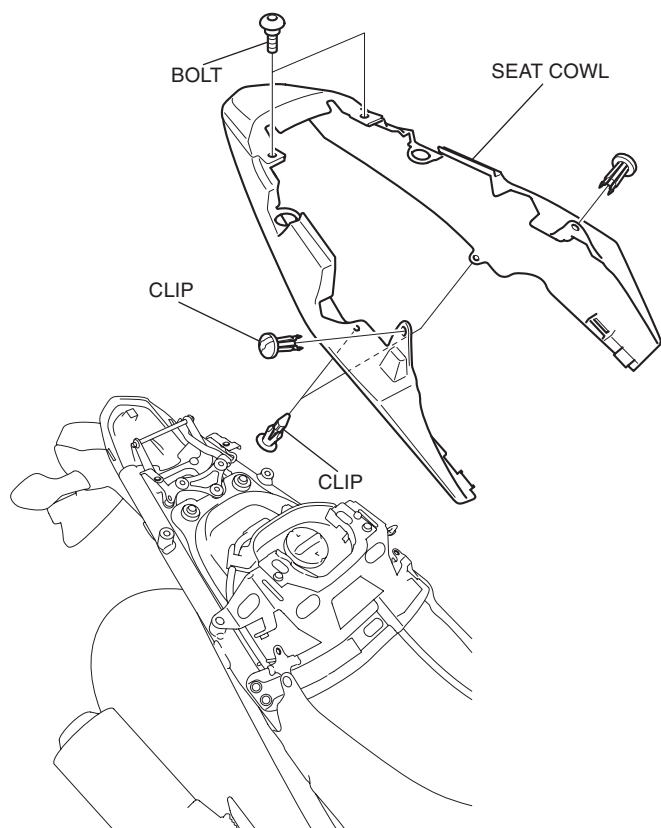

5. Cut and attach the template to the seat cowl and mark it using a marker as shown.

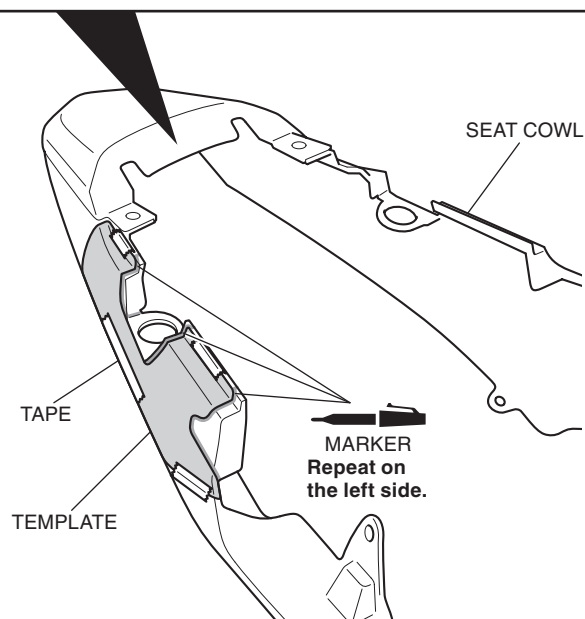
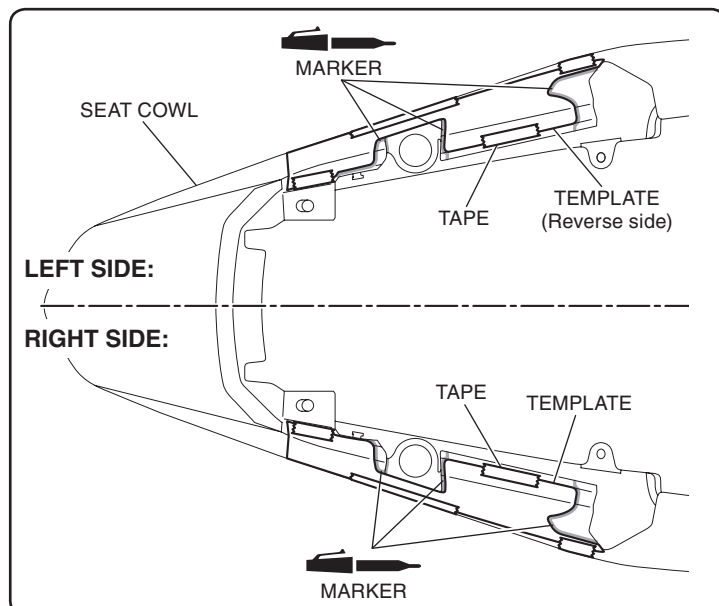

6. Remove the template. Work upon the seat cowl as shown.

- Repeat on the left side.

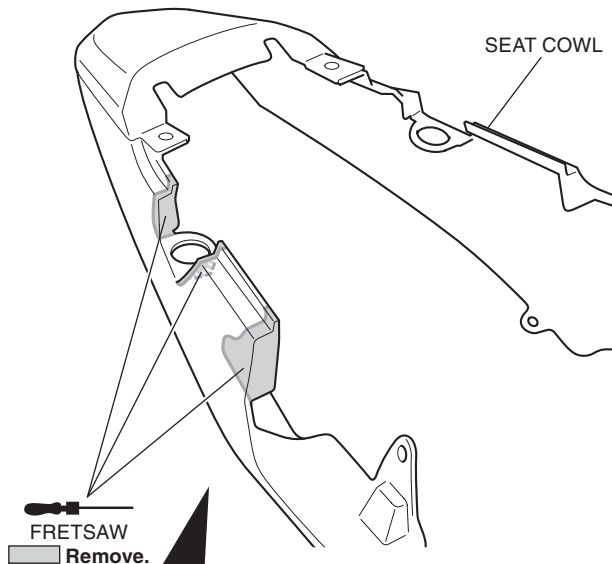

Remove any burrs.

FILE
File off the cutout surfaces
after removing the grey area.

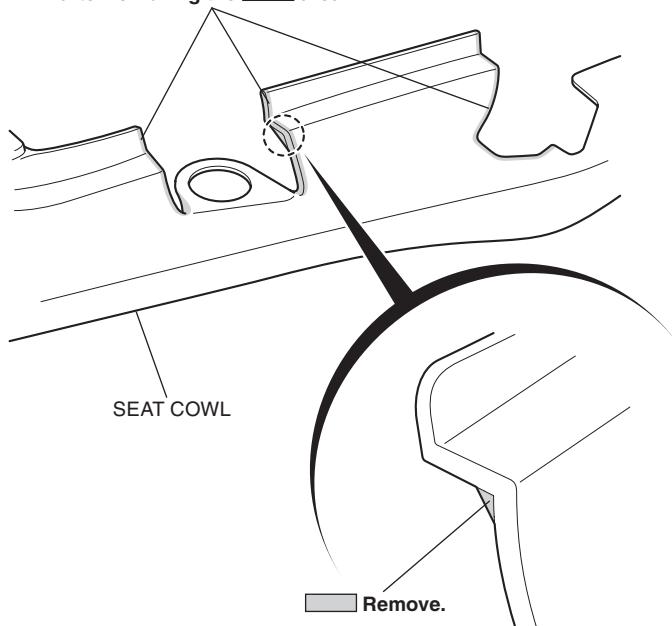

7. Install the seat cowl in the reverse order of removal.

8. Install the pillion seat hinge as shown.

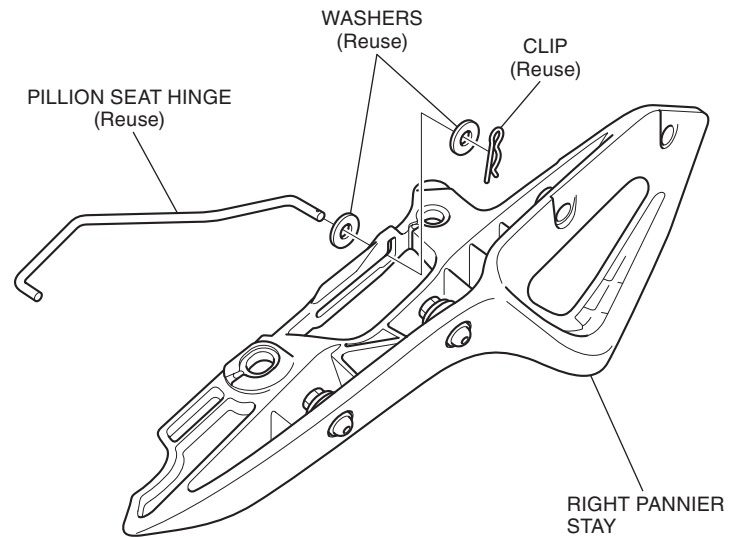

9. Loosely install the pannier stays as shown.

- Do not install the plugs yet.

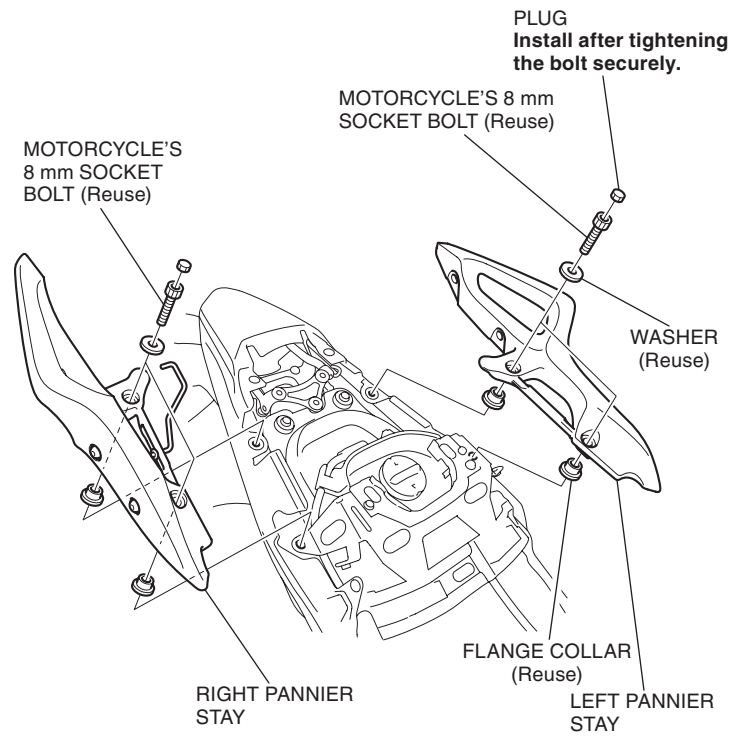

10. Loosely install the rear carrier as shown.

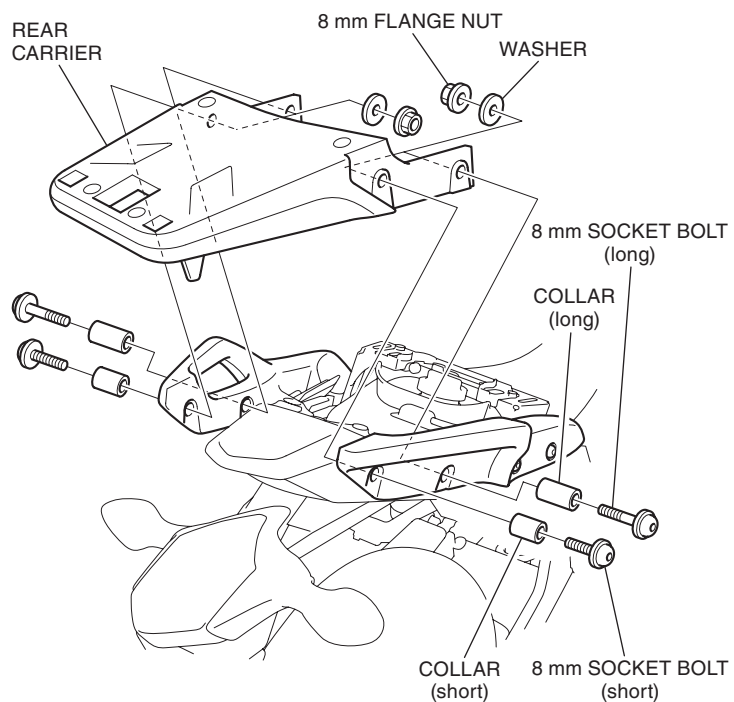

11. Tighten all loosely installed hardware to the specifications in the torque chart.

12. Install the removed parts in the reverse order of removal.

13. Install the rubbers as shown.

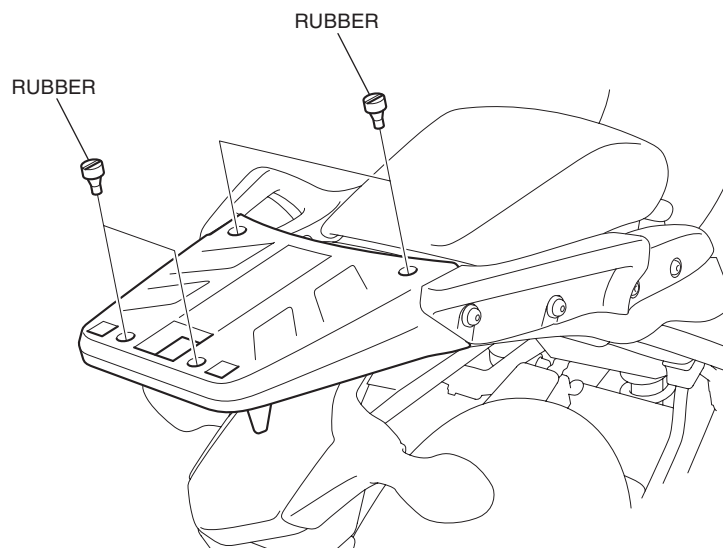

14. Attach the caution label in the position shown.

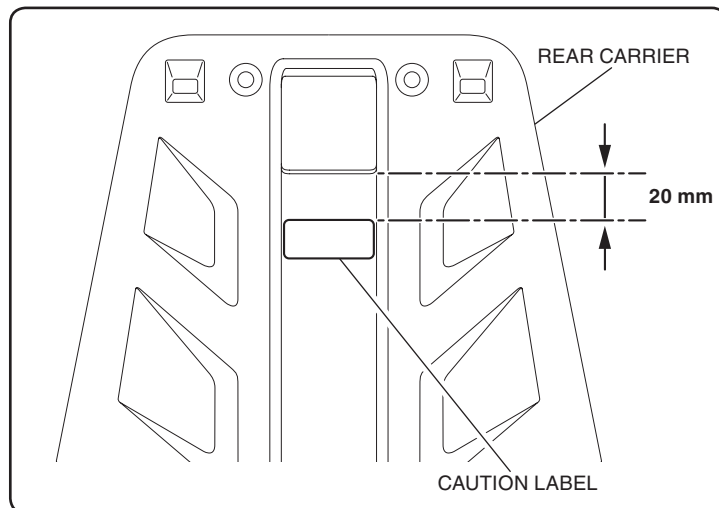

CAUTION LABEL
Remove the adhesive backing before attaching.

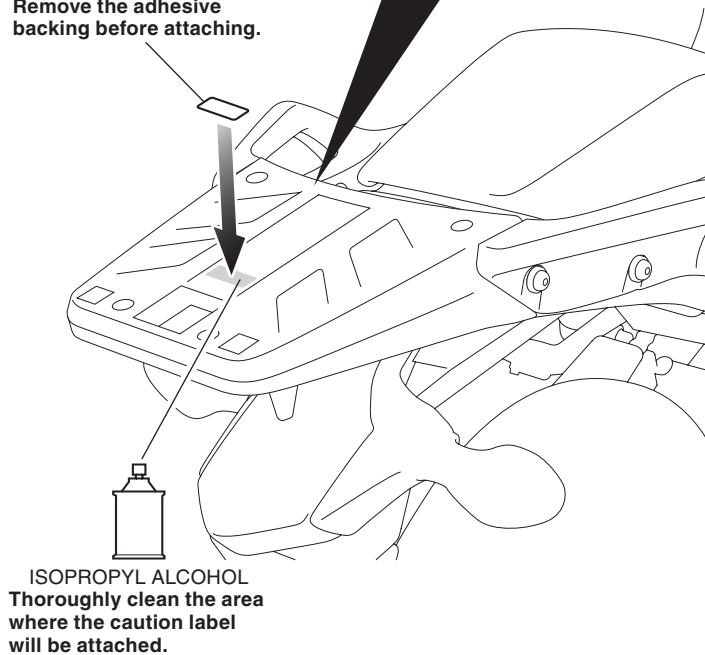

INSTALLATION <NC700D>

1. Refer to the Service Manual for the motorcycle, remove the motorcycle parts.

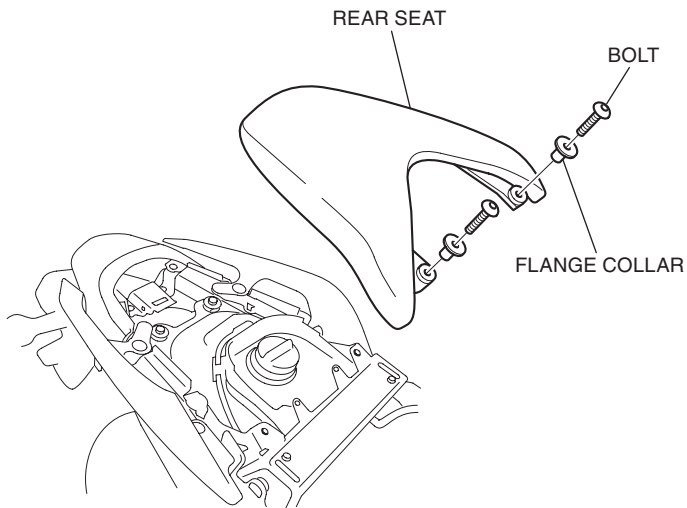

2. Refer to the Service Manual for the motorcycle, remove the motorcycle parts.

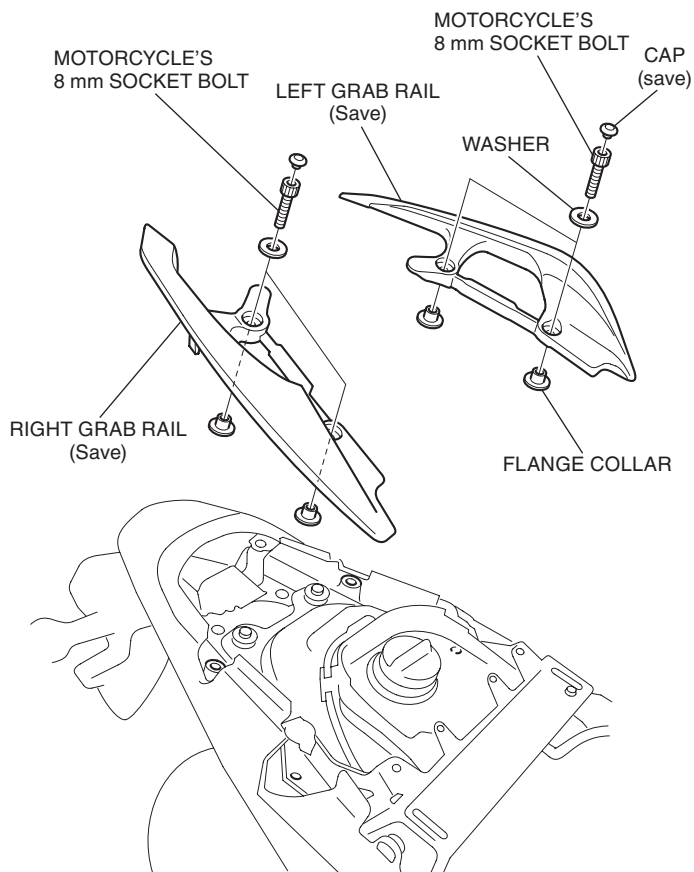

3. Refer to the Service Manual for the motorcycle, remove the motorcycle parts.

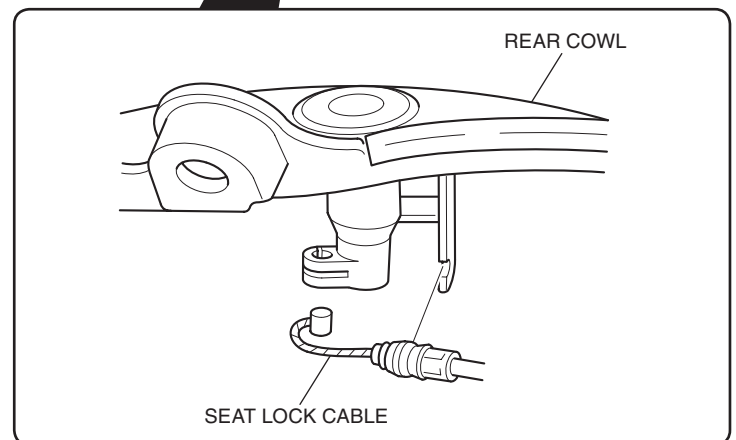
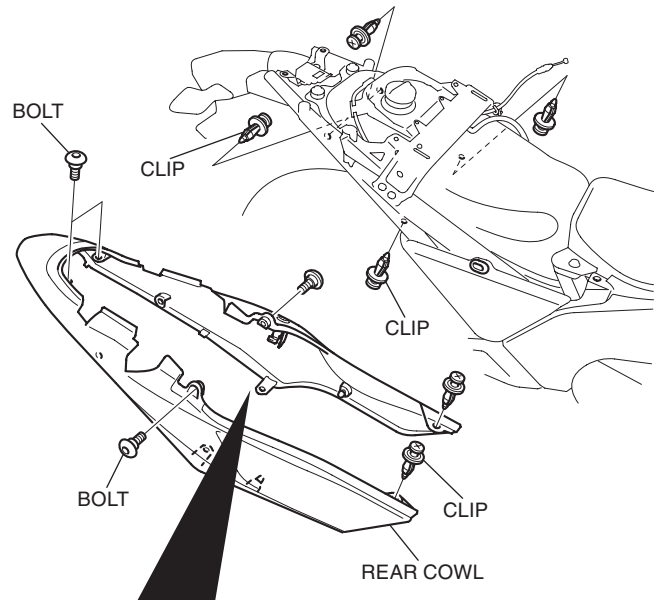

4. Cut and attach the template to the rear cowl and mark it using a marker as shown.

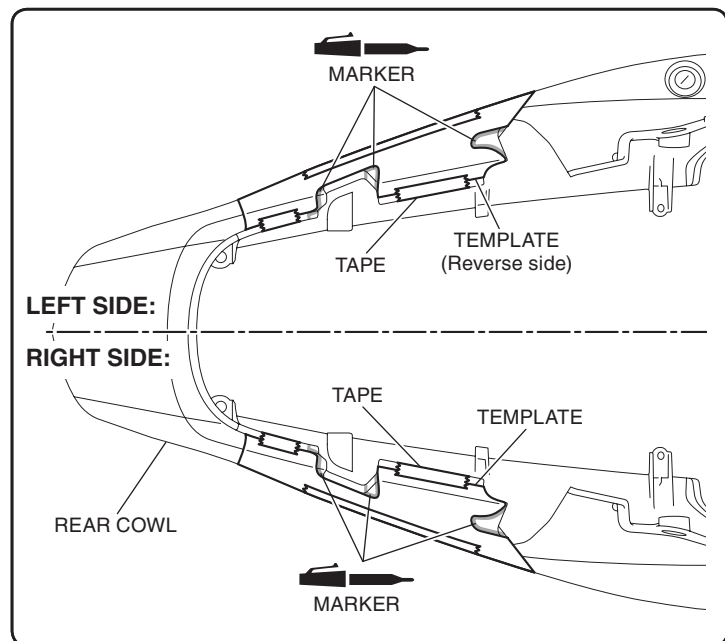

5. Remove the template. Work upon the rear cowl as shown.
- **Repeat on the left side.**

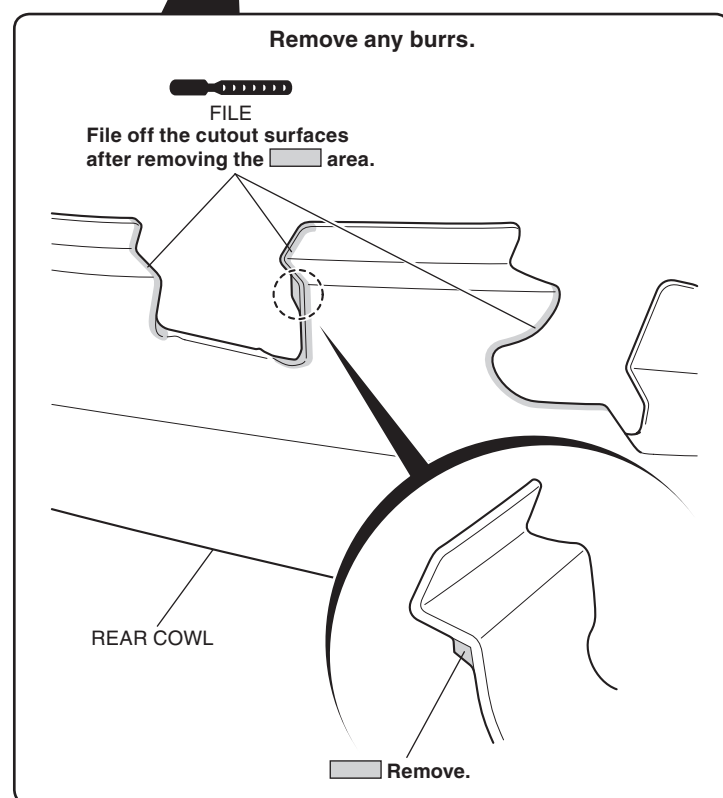
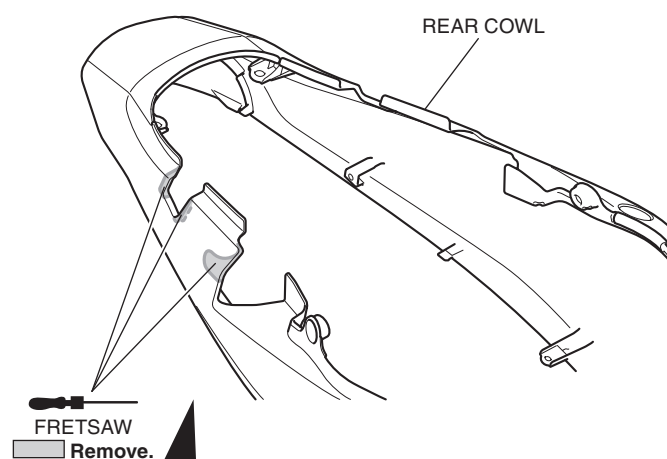

6. Install the rear cowl in the reverse order of removal.

7. Loosely install the pannier stays as shown.

- **Do not install the plugs yet.**

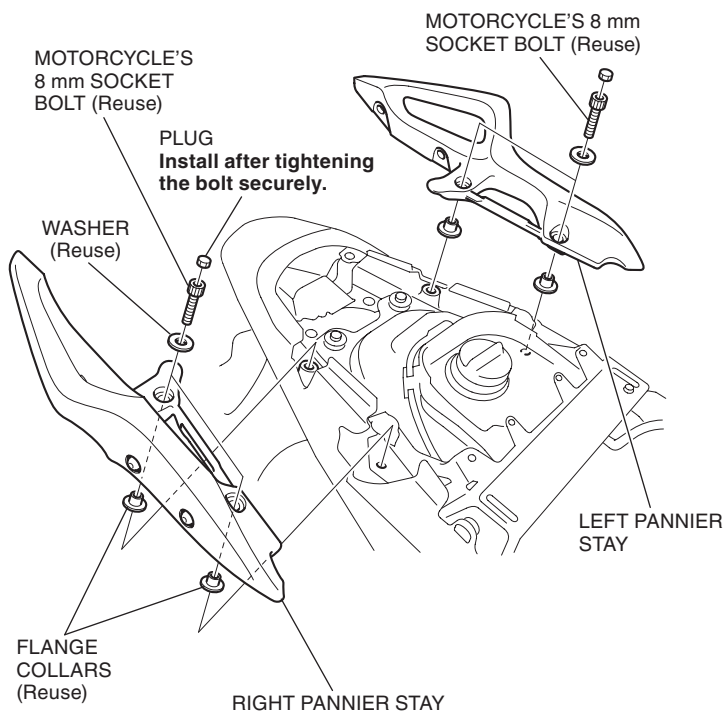

8. Loosely install the rear carrier as shown.

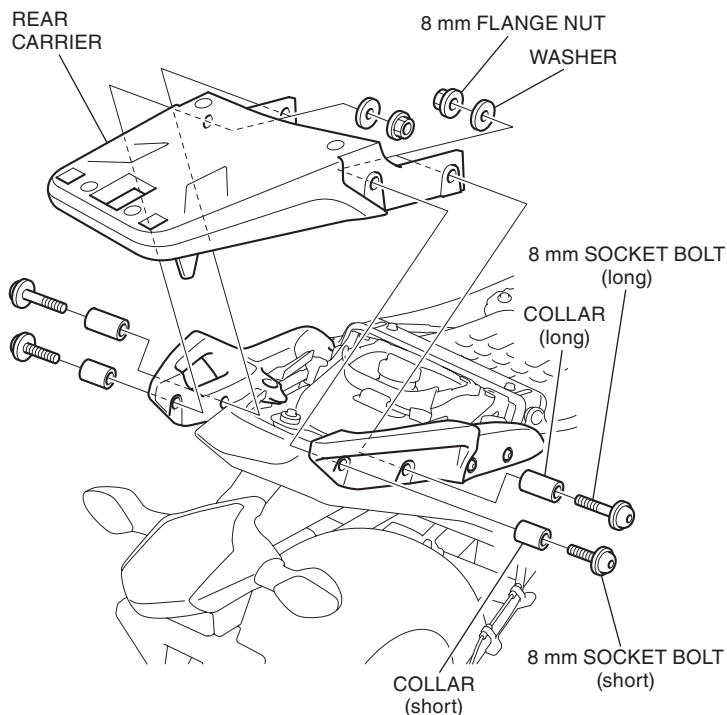

9. Tighten all loosely installed hardware to the specifications in the torque chart.

10. Install the removed parts in the reverse order of removal.

11. Install the rubbers as shown.

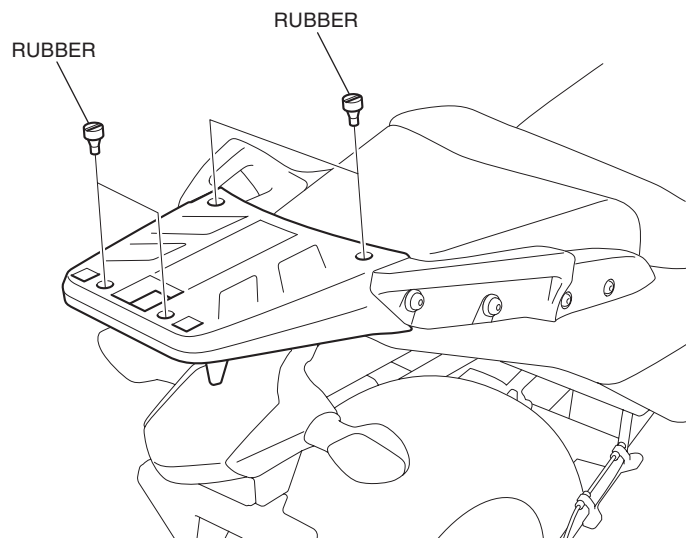

12. Attach the caution label in the position shown.

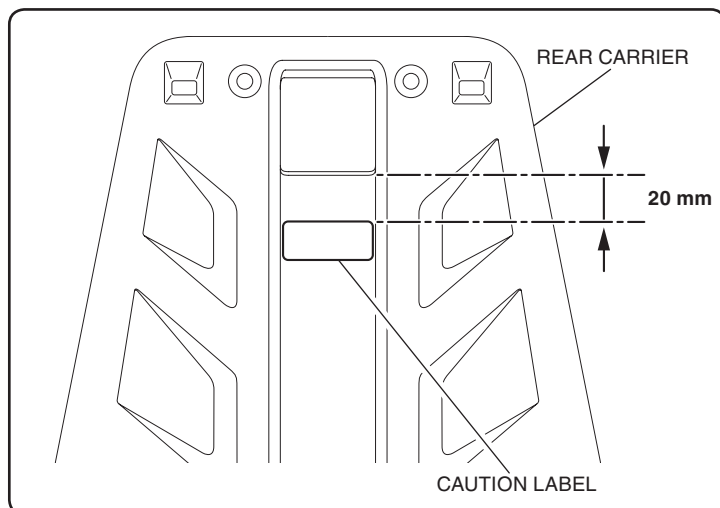

CAUTION LABEL
Remove the adhesive backing before attaching.

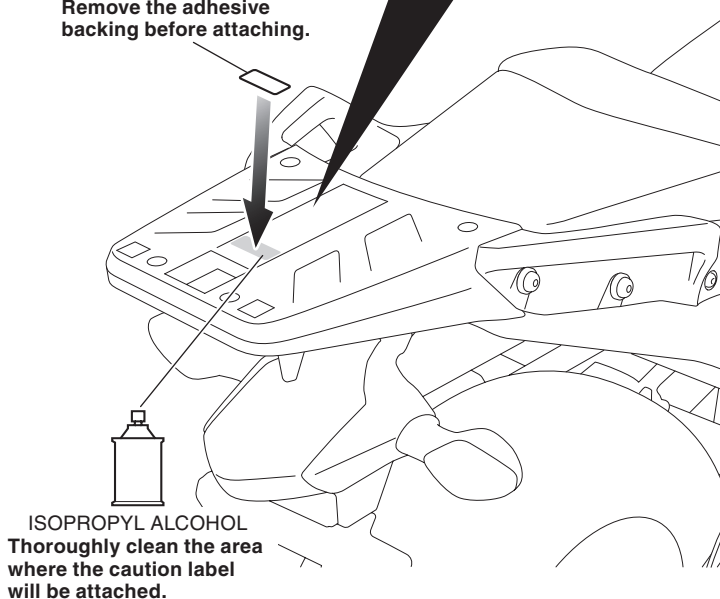

<TEMPLATE>

NC700X/XA/XD/S/SA/SD:

Cut off along the dotted line.

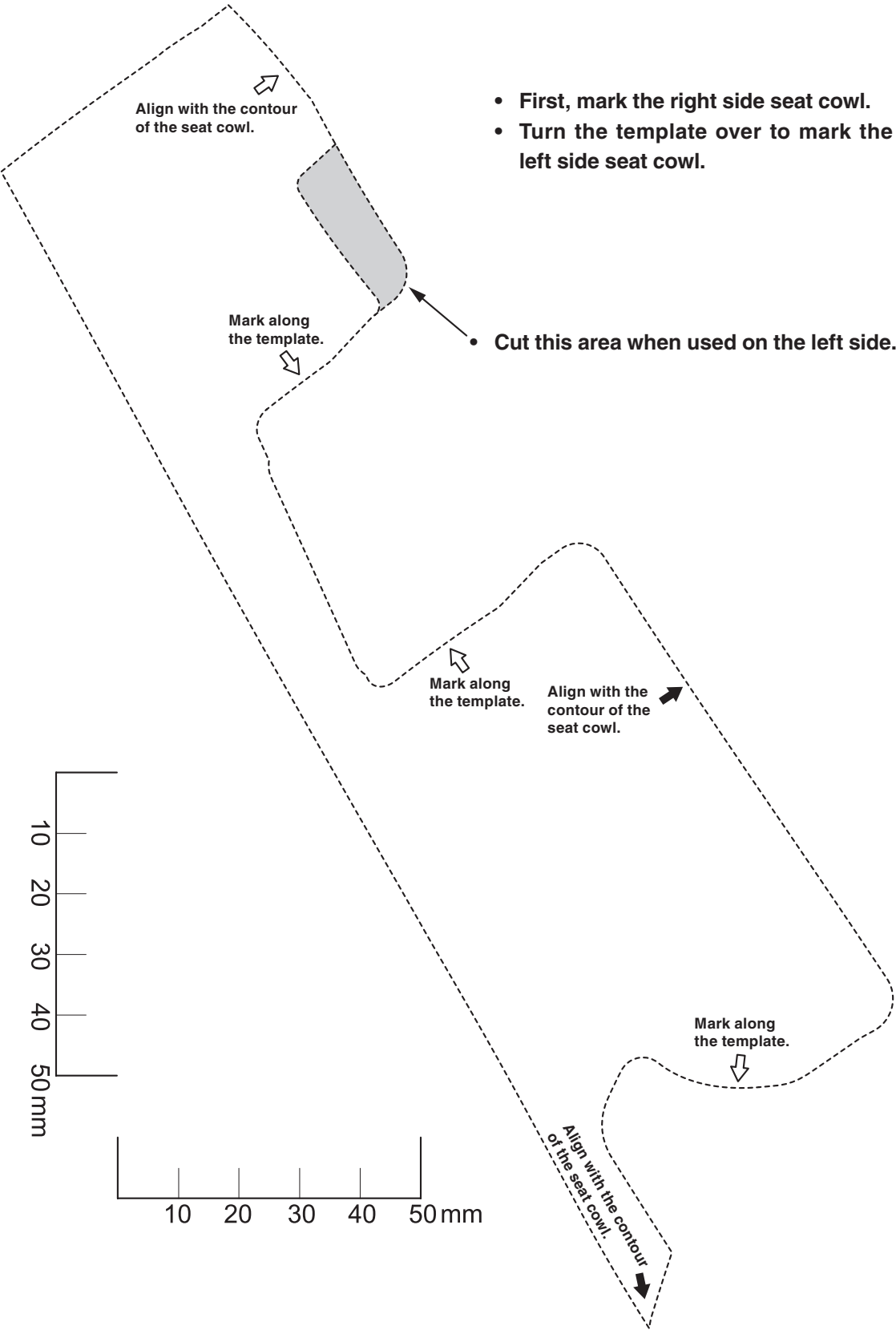

<TEMPLATE>

NC700D:

Cut off along the dotted line.

