

Honda Genuine Accessories

1 KEY TOP BOX (40L) INSTALLATION INSTRUCTIONS

Publications No.

Issue Date
January 2012

Honda Dealer:

Please give a copy of these instructions to your customer.

PARTS LIST

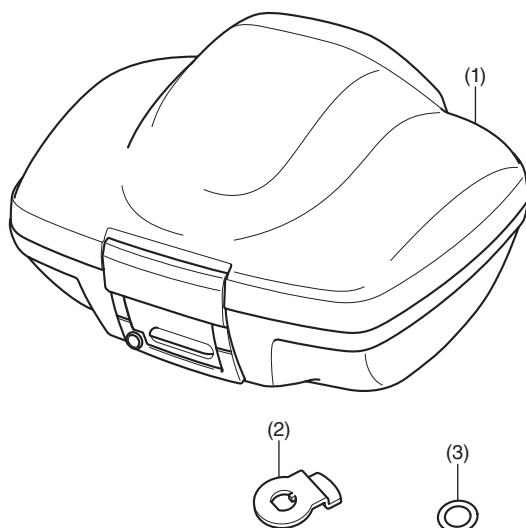

No.	Description	Qty
(1)	Top box	1
(2)	Plate	1
(3)	Washer	1

1 KEY CYLINDER

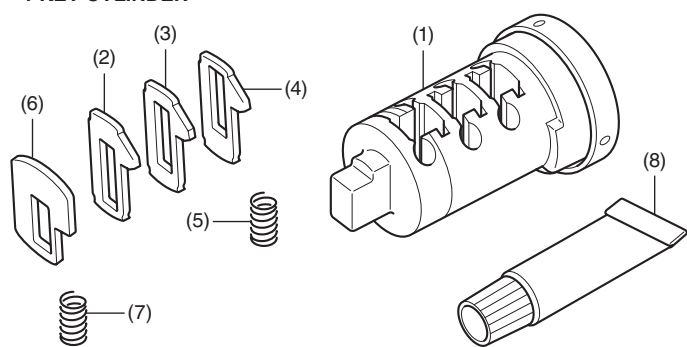

No.	Description	Qty
(1)	Inner cylinder	1
(2)	Tumbler A	5
(3)	Tumbler B	5
(4)	Tumbler C	5
(5)	Spring (Silver)	10
(6)	Stopper tumbler	3
(7)	Stopper spring (Black)	3
(8)	Grease	1

1 KEY BODY PARTS

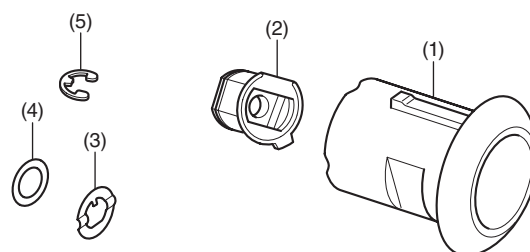

No.	Description	Qty
(1)	Cylinder body	1
(2)	Inner joint	1
(3)	Spring plate	1
(4)	Washer (Not used.)	1
(5)	E-ring	1

CARRIER BASE / BRACKET...etc.

Sold separately

- These are necessary depending on models, and the kit is different for each model.

< Notes regarding the key cylinder >

- This product is used to assemble a key cylinder matching the motorcycle key by combining three types of tumblers.
- When this key cylinder is installed in a box or similar equipment, the installed equipment can be operated with the motorcycle key.

Combine three types of tumblers.

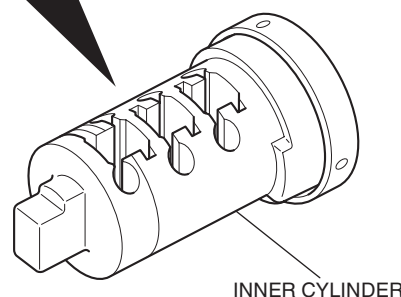
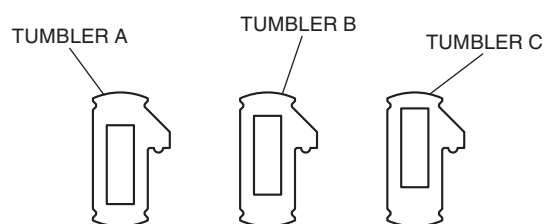

USE AND CARE INFORMATION

- The weight of the cargo must not exceed the following maximum weight capacity:

Top box	
Loading Capacity	<ul style="list-style-type: none"> Subtract the top box's empty weight from the rear carrier's capacity. When an accessory is installed in the top box, deduct the weight of that accessory from the loading capacity of the top box.
Empty Weight	5 kg (11 lb)

- Check the accessory mounts frequently.
- Do not store valuables or easily breakable items into the box.
- Don't place a heavy object on the opened lid or apply an excessive force from the top of opened lid.
- Be sure that the top box is installed securely before riding.
- The top box is not perfectly watertight, and water may enter when washing the motorcycle, when it rains, etc.
- Added accessories can affect a motorcycle's stability, performance and safe riding speed.

INSTALLATION

- The three tumbler types shown are provided.
 - The  part has a different width for each of the three tumbler types.
 - As the tumblers are small, keep them in the bag until they are used.

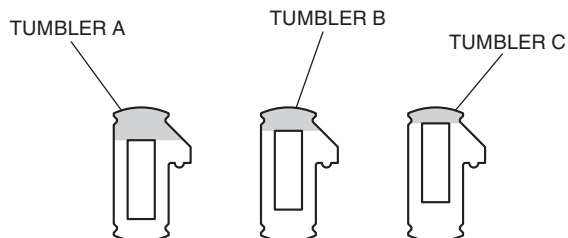

The stopper tumbler will be used later.

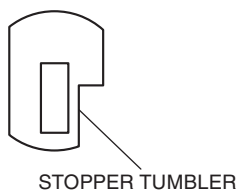

- Install the tumbler and the spring (silver) as shown.
 - Install five tumblers of the same type out of the three types.

Insert tumbler and spring at the indicated position.

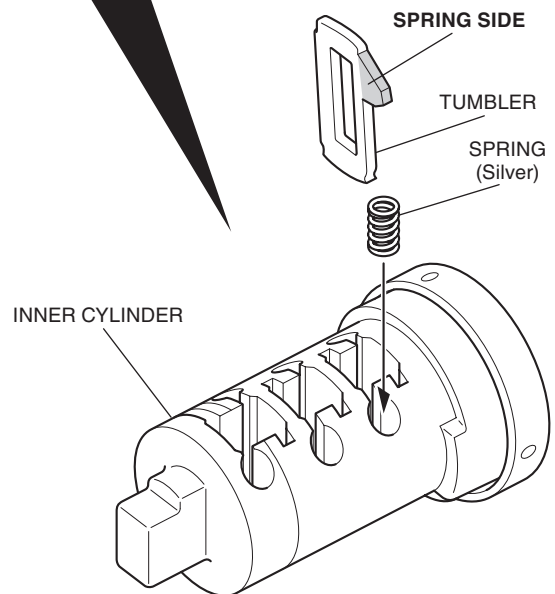
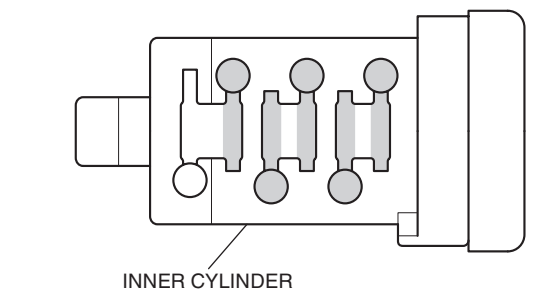

- Insert the key as shown.
 - Lightly push down on the tumblers from above, then insert the key.

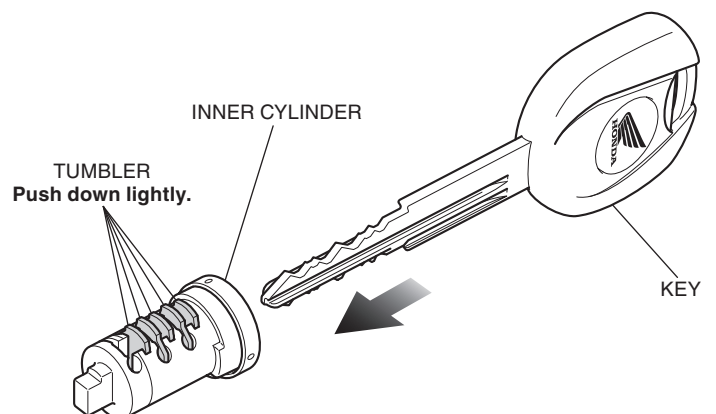

4. Confirm the tumblers are projecting as shown at their respective positions.

- **The positions where tumblers project and the projecting height differ according to the key.**

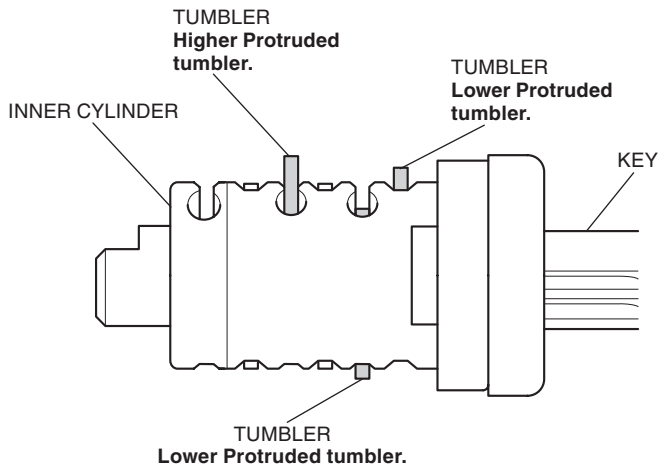

5. Press down lightly on the tumblers, pull the key.

- **The tumbler spring may jump out when the tumbler is not pressed down lightly.**

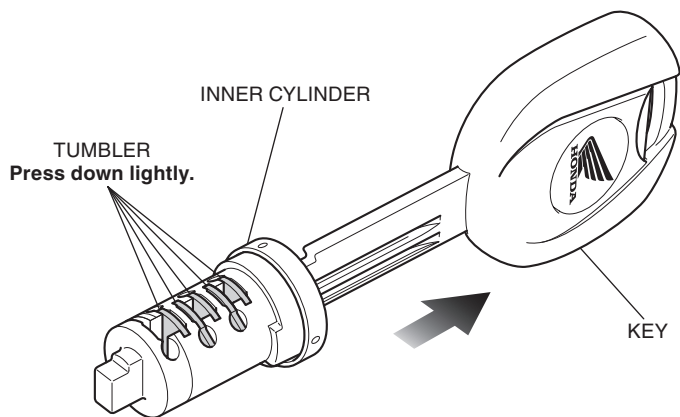

6. Pull out the projecting tumbler.

- **Leave the spring installed.**

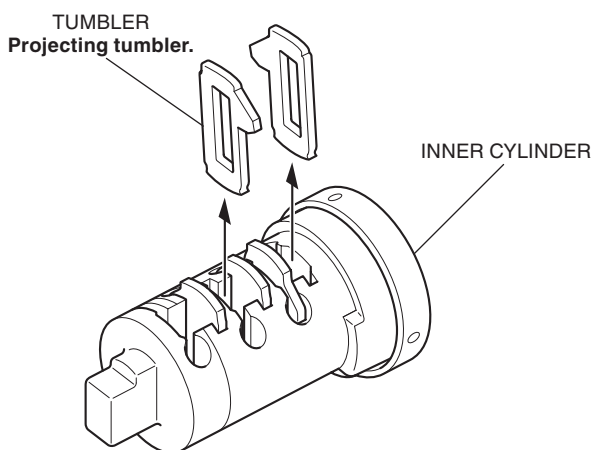

7. Insert a different tumbler at the position after pulling out the tumbler.

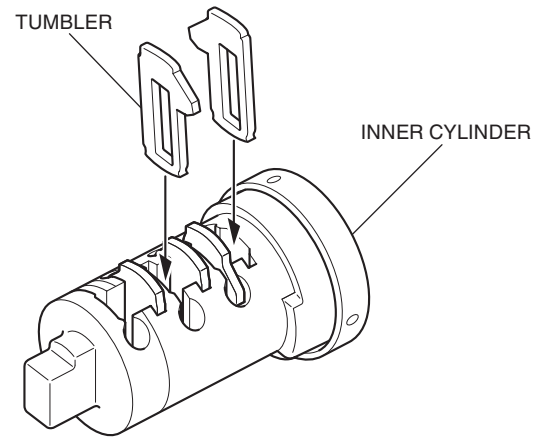

8. Perform steps 3 to 7. Insert the key as shown and confirm that all tumblers remain inside.

- **Lightly push down on the tumblers from above, then insert the key.**

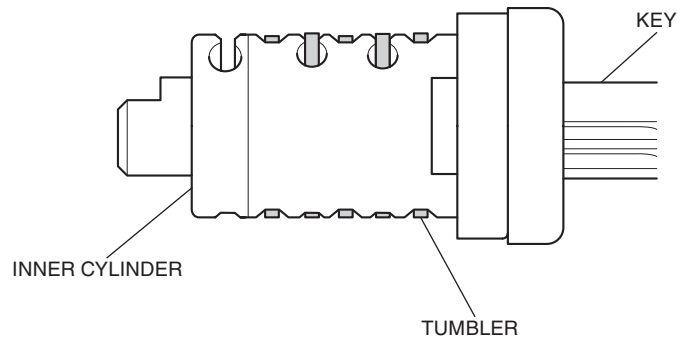

9. Insert the inner cylinder as shown.

- **Confirm the inner cylinder turning clockwise smoothly.**

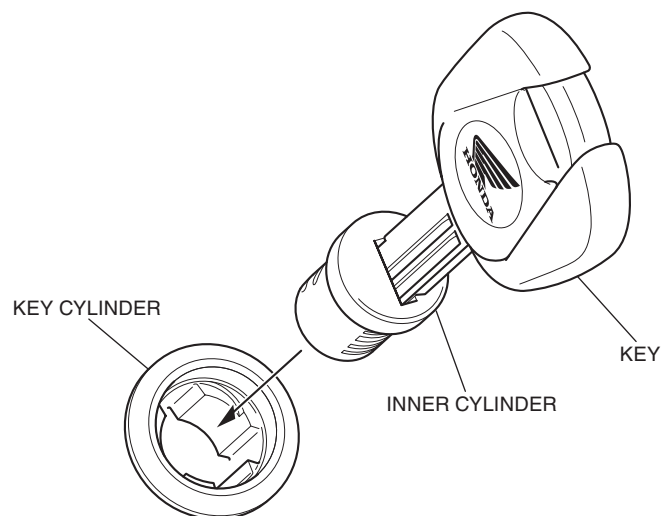

10. Pull the inner cylinder.

11. Push down lightly on the tumblers and pull the key.

12. Install the stopper tumbler and the stopper spring (black) as shown.

Insert a stopper tumbler and a stopper spring at the indicated position.

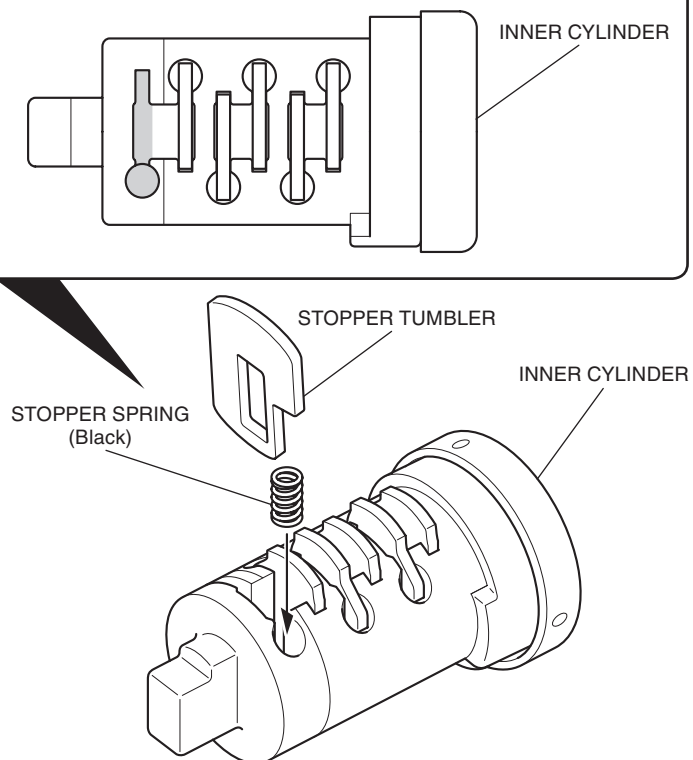

13. Insert the key as shown.

- Lightly push down on the tumblers from above, then insert the key.
- Confirm that the stopper tumbler jumps out.

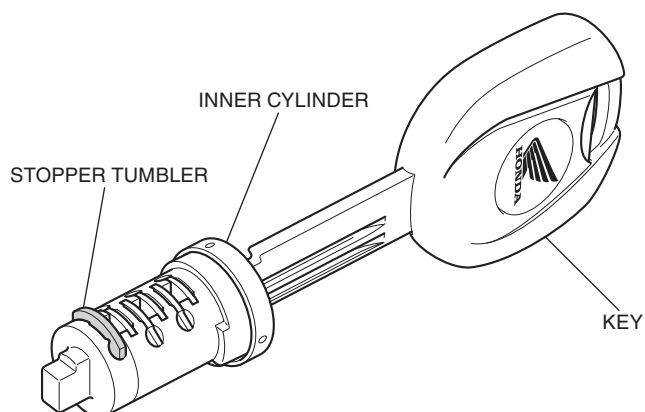

14. Apply grease to the position shown.

- Apply to the tumbler part and to the outer circumference of the inner cylinder.
- Only use the supplied grease.

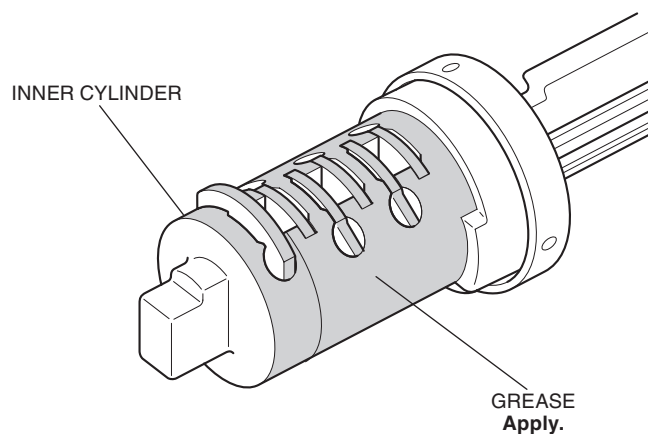

15. Install the inner joint in the cylinder body as shown.

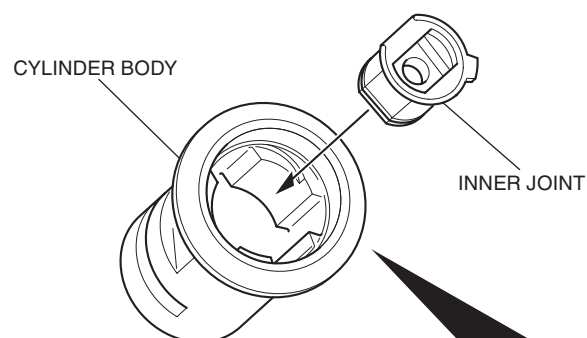

Align with the groove.

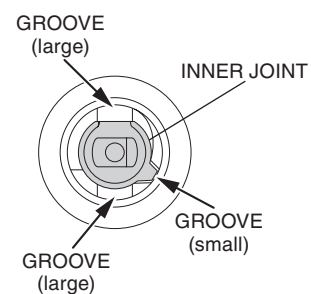

16. Install the inner cylinder by sliding the stopper tumbler along the slide guide while rotating it.

- If the inner cylinder cannot be inserted, again confirm that no tumblers other than the stopper tumbler have jumped out.

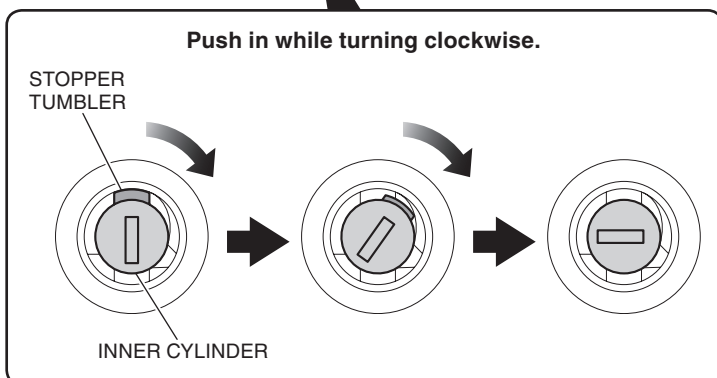
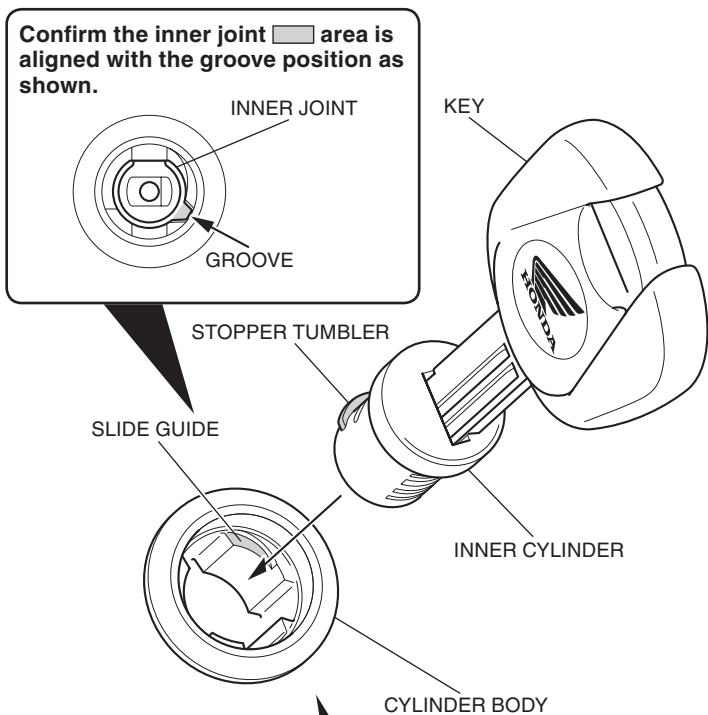

17. Draw out the key and check that the inner cylinder does not come out.

18. Install the cylinder body on the top box as shown.

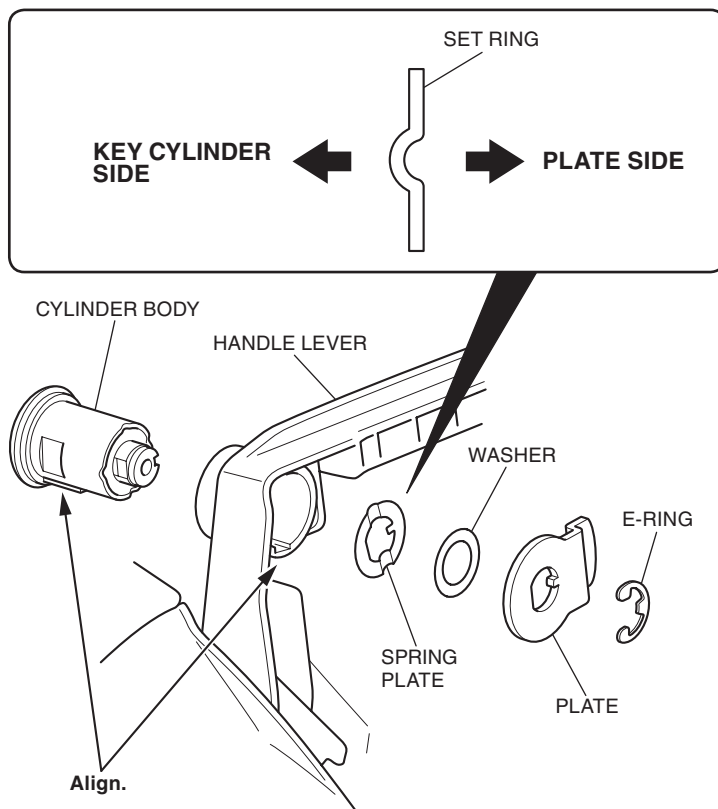

How to Open and Close the Top Box

1. Release the lock by turning the key clockwise.

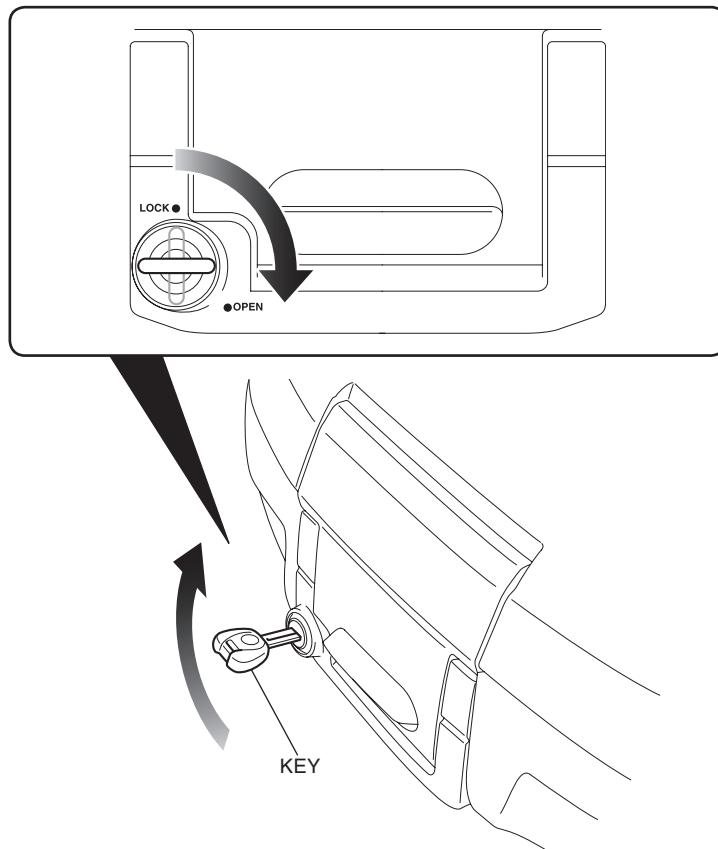

2. With the key turned clockwise, raise the plate lock and release it from the lid.

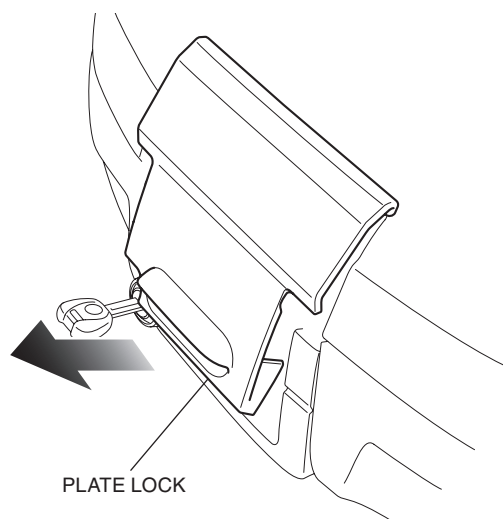

3. Open and close the lid with the plate lock released and raised.

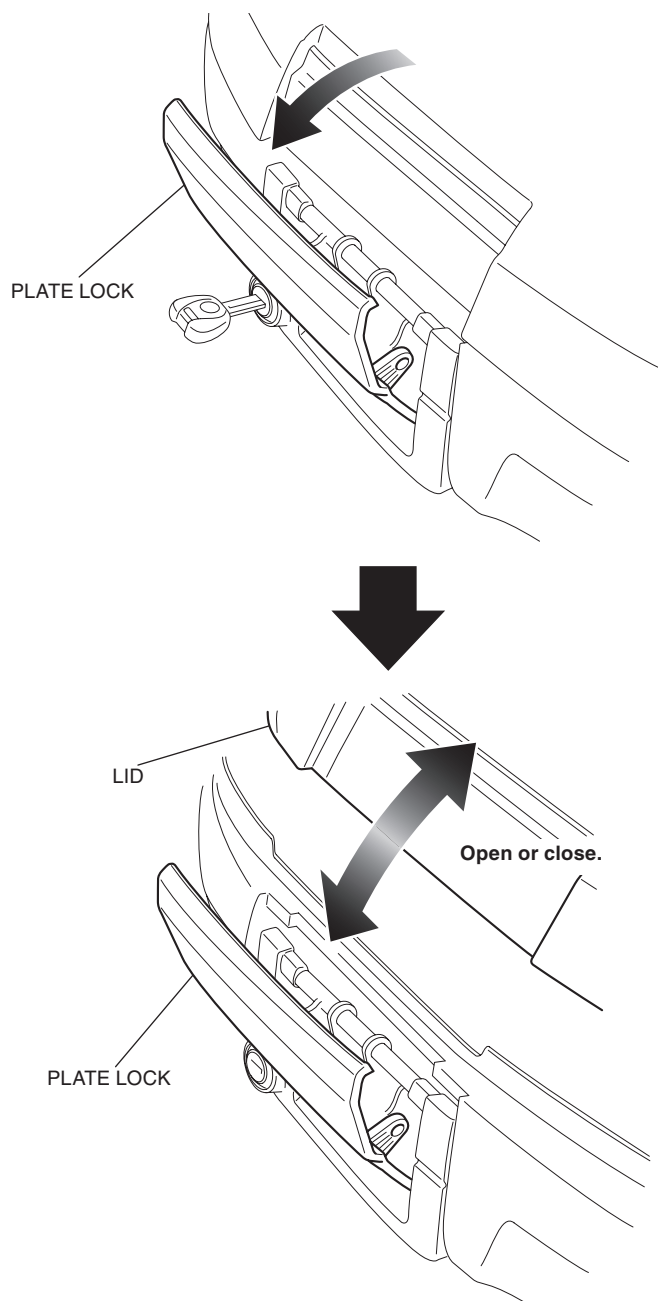

How to Install the Top Box

1. Release the lock by turning the key clockwise.

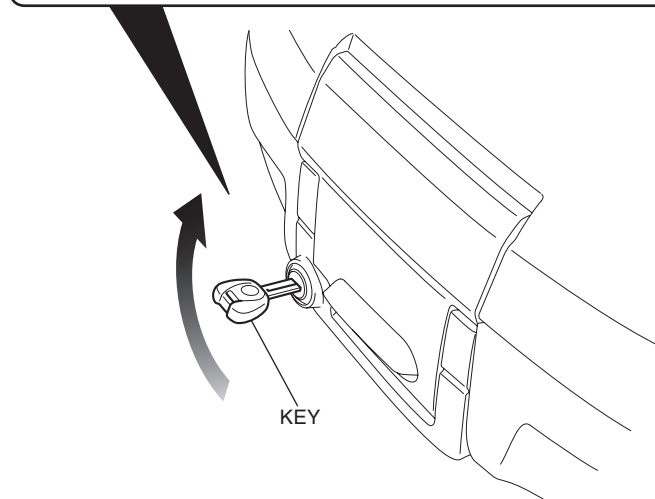
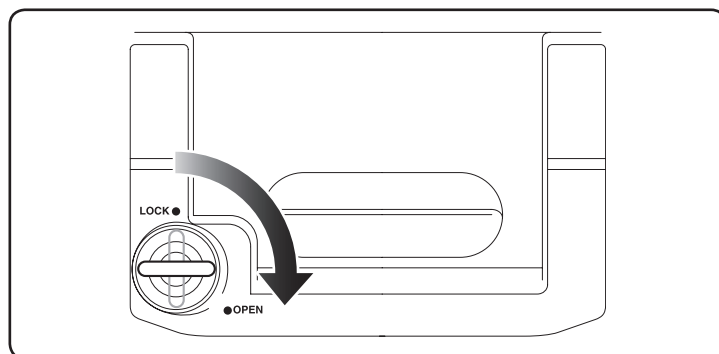

2. Install the top box on the rear carrier.

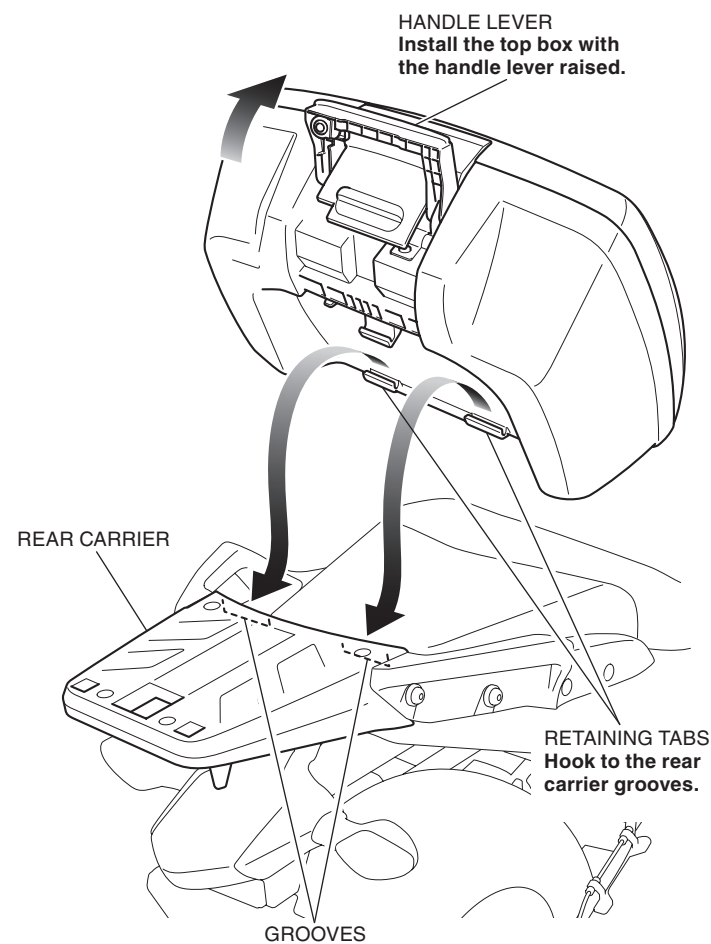

3. Lower the handle lever as shown.

Lower the handle lever until the label is hidden as shown.

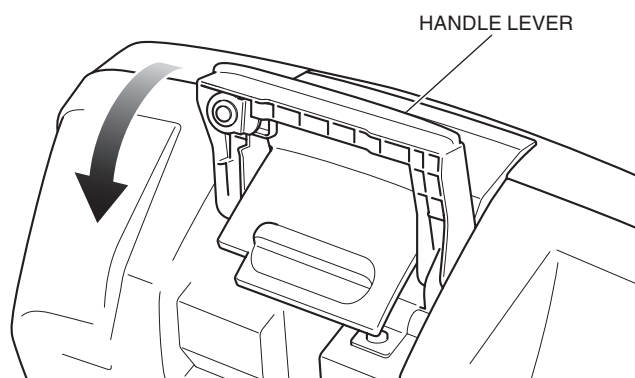
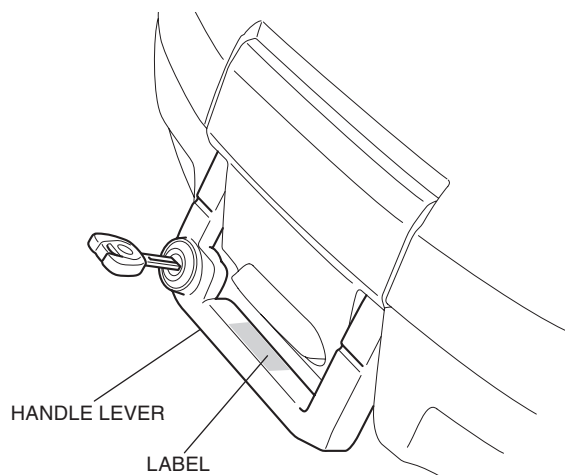

4. Lock the top box by turning the key counterclockwise.

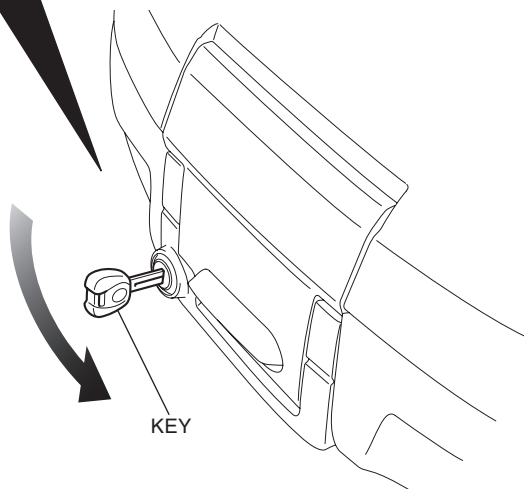
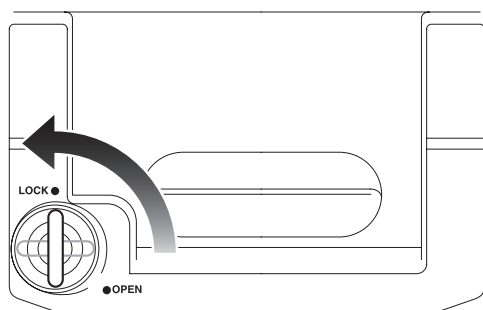

5. Be sure that the handle lever cannot be released and the top box is installed securely.

- The top box can come off during riding unless it is mounted securely.

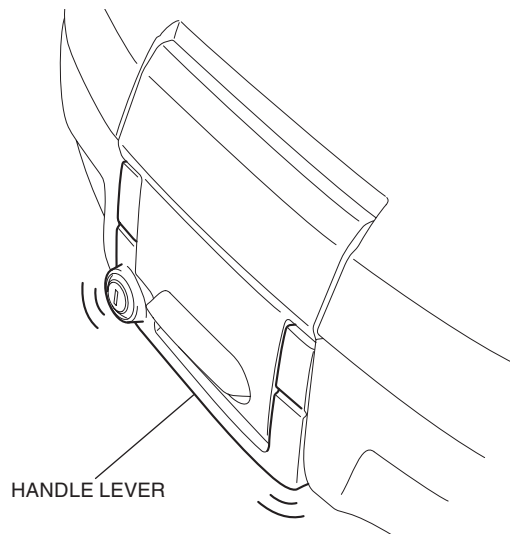

How to Remove the Top Box

1. Remove the top box in the reverse order of installation.